

## Support available



### Installation videos

Available on [yaledws.co.uk](http://yaledws.co.uk) and youtube



### End user videos

Available on [yaledws.co.uk](http://yaledws.co.uk) and youtube



### Installation guide

Easy to follow installation guide/booklet



### Maintenance

Ongoing maintenance guidance and record log



Yale Door and Window Solutions  
School Street  
Willenhall  
West Midlands  
WV13 3PW

**THE YALE BRAND**, with its unparalleled global reach and range of products, reassures more people in more countries than any other consumer locking solution.

**THE ASSA ABLOY GROUP** is the world's leading manufacturer and supplier of locking solutions, dedicated to satisfying end-user needs for security, safety and convenience.

Yale Panic push bar user  
Issue 02 01.01.2023



The world's favourite lock since 1843

## Lockmaster® Panic Exit Device User Guide

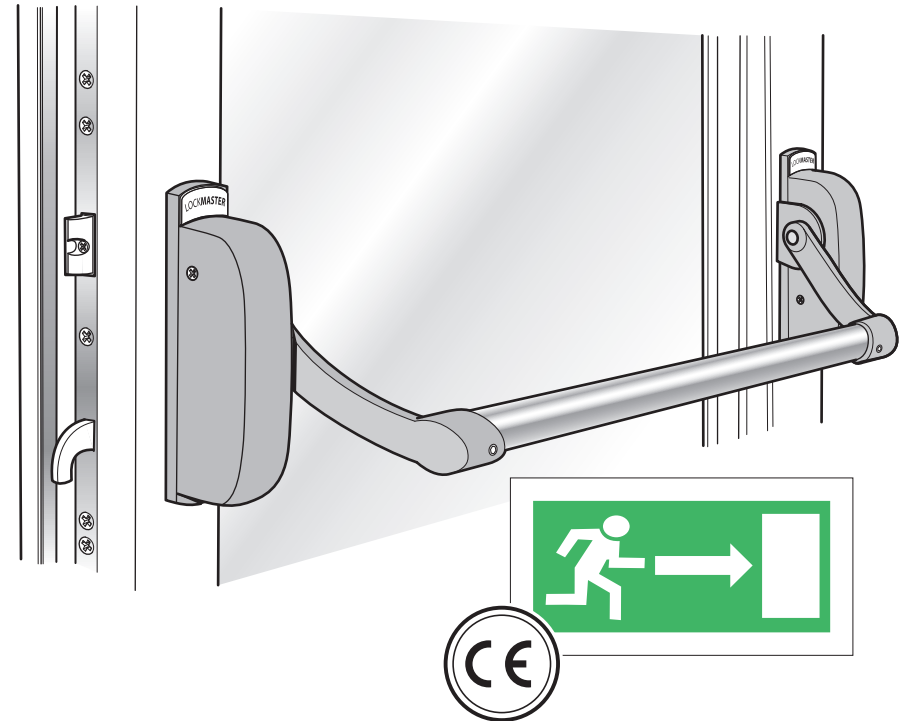

**LOCKMASTER®**  
MULTI-POINT PANIC DOOR LOCK

	Page
Index .....	02
Operations .....	03
Maintenance and service inspection Panic push bar functionality test .....	04
Maintenance and service inspection Optional Outside Access Device .....	05
Maintenance Log Book .....	06-11
Support .....	12



**PED1000 Panic Exit Device** European Patent Application  
No. 09155542.5

The safety features of this exit device are of fundamental importance to ensure its compliance with European Standard EN1125.

No modifications of any kind to the device other than those described in the fitting instructions are permitted.

Attention: Exit devices shall not include dogging (hold unlocked) when fitted to fire or smoke door assemblies.

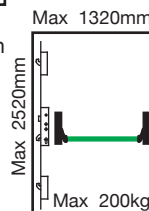

It is illegal to place windows and external pedestrian doorsets on the market without a CE mark and a Declaration of Performance. This is due to the European Construction Products Regulation which is EU law. The approved method to demonstrate compliance with the Construction Products Regulation for external doors and windows is described in the European Standard EN 14351-1 windows and external pedestrian doorsets without resistance to fire and smoke leakage characteristic.

Requirements for emergency or panic exit devices falls under AVCP system 1 and requires that a Notified Body confirms your compliance by providing a Certificate of Constancy of Performance (CoCoP) for your doorset. Any emergency exit device or panic exit device fitted to a doorset must have been tested and CE marked (Certificate of Performance available on the Yale DWS Web Site) to relevant standards EN 179, EN 1125, prEN 13633 or prEN 13637.

European Patent Application No. 09155542.5

[illegible]

[illegible]

## Operations

## Operating Mortice Panic Device

### To lock device (from inside)

1. Close the door fully and engage the latch
2. Slide the green snib upwards approx 10mm
3. Pull cross arm towards you in an upward arc to throw hooks and rollers to the locked position - The hooks and rollers should engage in strikers

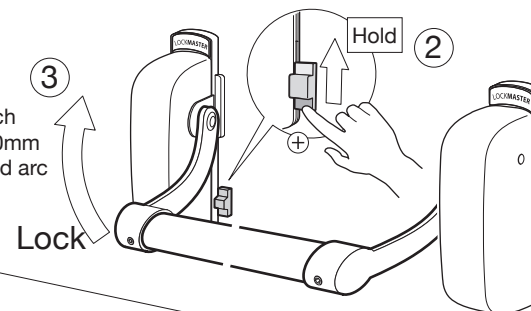

### To operate device (from inside)

1. Push cross arm towards door in a downward arc to release hooks and rollers allowing door to open

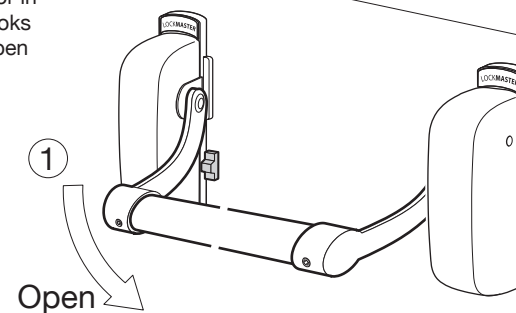

### Operating Outside Access Device

### To lock device (from outside)

1. Close the door fully and engage the latch
2. Insert key and rotate 145° until some resistance is felt
3. Turn key a further 35° - this will release lever
4. Lift the lever up to throw hooks and rollers to the locked position - the hooks and rollers should engage smoothly into strikers
5. The key can now be rotated back 180° and removed from cylinder

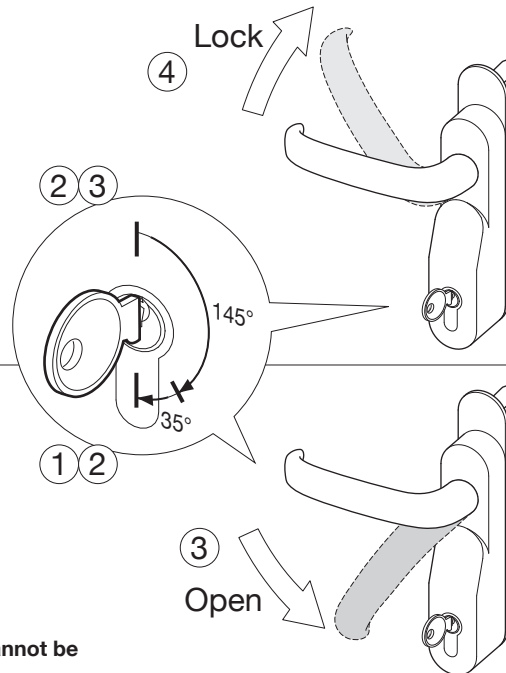

### To unlock device (from outside)

1. Insert key and rotate 145° until some resistance is felt
2. Turn key a further 35° - this will release lever
3. Push the lever downwards to release latch, hooks and/or rollers allowing door to open
4. The key can now be rotated back 180° and removed from cylinder

**Please note: The Outside Access Device cannot be left in the unlocked position.**

## Maintenance and service inspection

Undo covers and inspect parts and functionality

Oil moving parts

**See Maintenance pages**

### Keep log of inspections

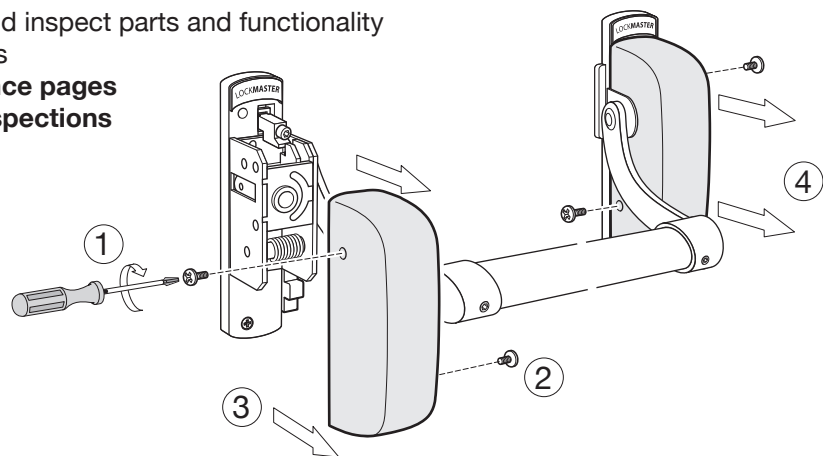

## Panic push bar functionality test

Test functionality  
Door 1

Test functionality  
Door 2  
(Double door system only)

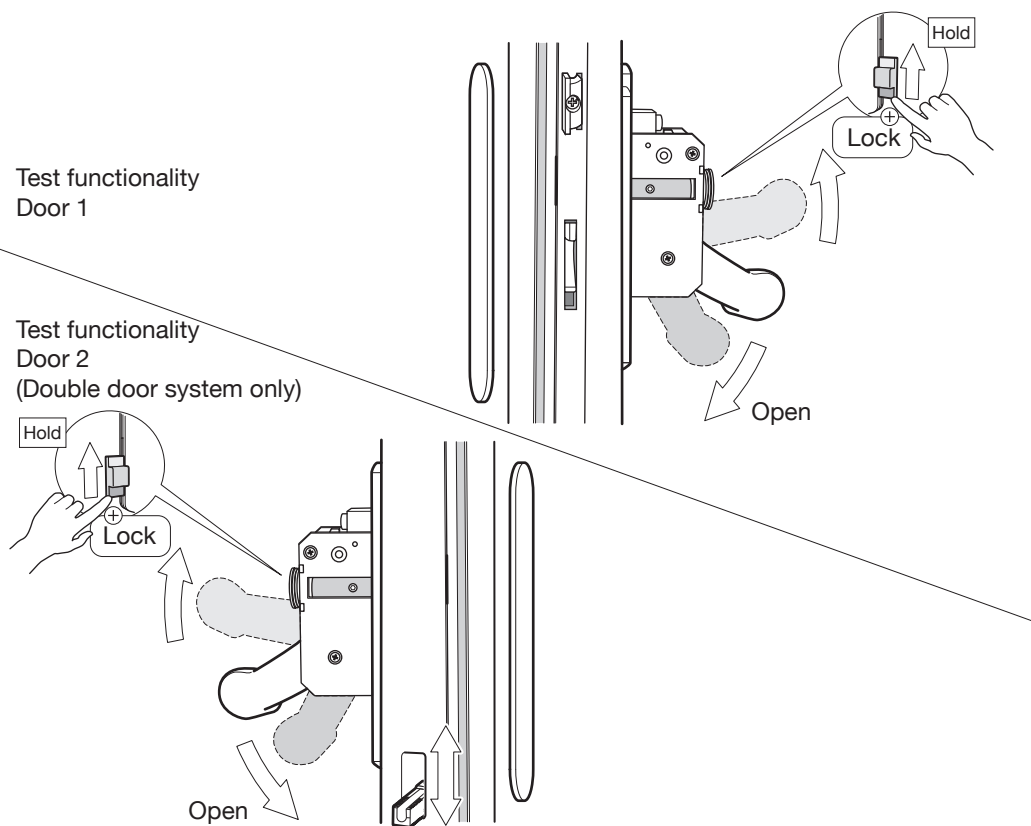

## Maintenance Log Book, page 4

European Patent Application No. 09155542.5

[illegible]

Installation and Maintenance Requirements  
for Panic Exit Devices  
**European Patent Application No. 09155542.5**

[illegible]

Undo covers and inspect parts and functionality

Oil moving parts

**See Maintenance pages**

### Keep log of inspections

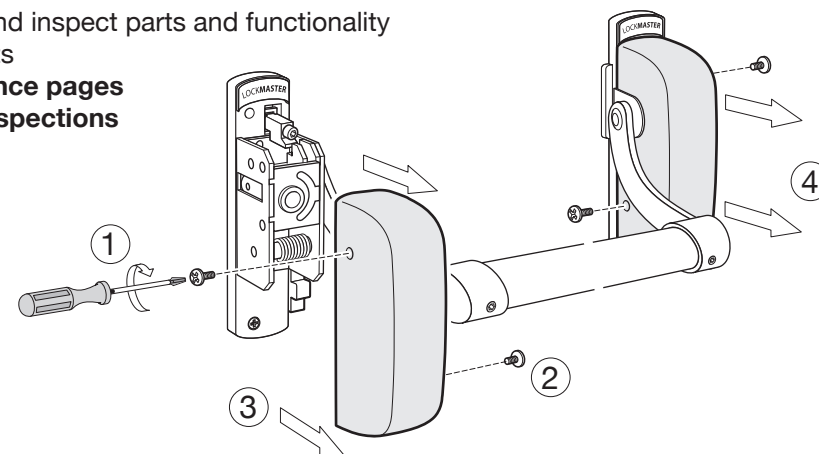

## Test functionality

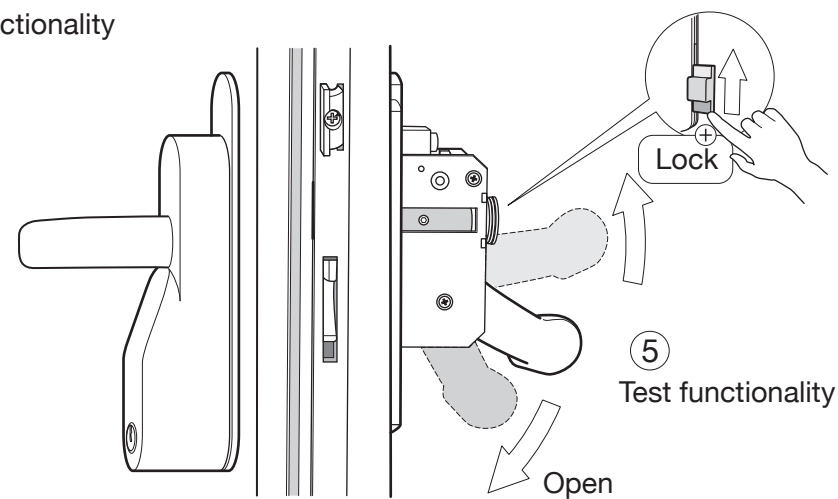

## Test functionality

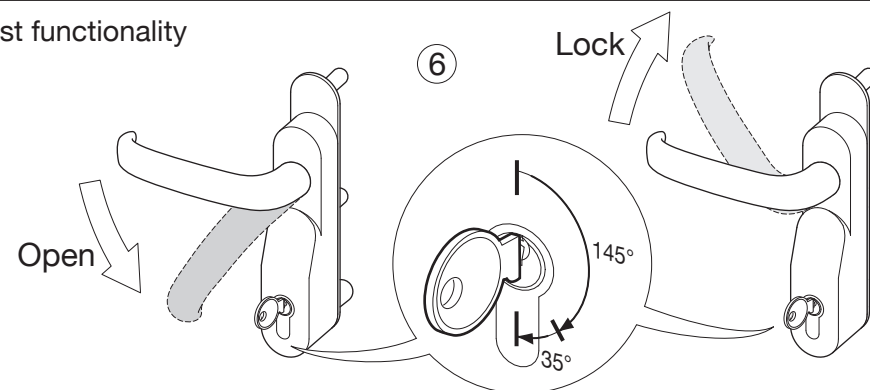

## Maintenance Log Book, page 1

Exit Door No.....

Location .....

## MAINTENANCE INSTRUCTIONS

European Patent Application No. 09155542.5

NOTE: To ensure performance in accordance with BS EN1125 the following routine maintenance checks should be undertaken at regular intervals.

## WEEKLY

1. A visual inspection and operation of the device to ensure that all components are working correctly.
2. Ensure that the strikers are free from obstruction and latches are fully extended when in the closed position.
3. Check for any loose components - tighten if necessary.

## MONTHLY

1. Check operation of device with door open several times - then again with door closed.
2. Ensure that the strikers are free from obstruction and latches are fully extended when in the closed position.
3. Remove covers and check that all moving parts of mechanisms and latches are lubricated.
4. Check operation of device with covers removed for any obstructions.
5. Check tightness of all fixing screws and replace covers.
6. Check that no additional locking devices have been added to the door since its original installation.
7. Check that all components of the devices are still correct in accordance with the list of approved components originally supplied with the system.
8. Check that the operating element is correctly tightened and, using a force gauge, measure the operating forces to release the exit device.

Check that the operating forces have not changed significantly from the operating forces recorded when originally installed.

## INSTALLATION AND FIXING INSTRUCTIONS

NOTE: Exit devices manufactured in accordance with BS EN1125 will provide a high degree of safety for people and reasonable security for property provided that they are fitted to doors and door frames in good condition. The safety features of the devices are of fundamental importance to ensure its compliance with the standards. No modifications of any kind other than those described in the Installation instructions are permitted.

1. Installation instructions specifying appropriate fixing arrangements for the various door types are included with each exit device.
2. Before fitting an exit device, the door should be checked to ensure correct hanging and freedom from binding. It is not recommended that exit devices should be fitted to hollow core doors unless specifically designed by the manufacturer for this type of door. It is recommended to verify that the door construction allows the use of device. i.e. to verify that offset hinges and engaging leaves allow both leaves to be opened simultaneously, or to verify that the gap between door leaves does not differ from that defined by the manufacturer, or to verify that the operating elements do not interfere etc.
3. Before installing an exit device to a fire/smoke door, the certification should be examined to ensure the suitability of the device for that door assembly. It is of utmost importance that an exit device is not used on a door assembly of a greater resistance time than approved for.
4. Care should be taken that any seal or weather-strip fitted to the door assembly does not inhibit the correct operations of the device.

## Maintenance Log Book, page 2

Installation and Maintenance Requirements  
for Panic Exit Devices

## INSTALLATION AND FIXING INSTRUCTIONS

European Patent Application No. 09155542.5

5. On double doorsets with rebated meeting stiles and where both leaves are fitted with exit devices, it is essential to check that either leaf will open when its respective device is activated and also that both leaves will open freely when both exit devices are operated simultaneously.
6. Where exit devices are manufactured in more than one size please ensure the correct size is selected.
7. Category 2 (standard projection) exit devices should be used in situations where there is restricted width for escape, or where the doors are not able to open beyond 90°
8. Where a device is fitted to a glazed door, it is essential that the glazing should be toughened or laminated glass.
9. Alternative fixing screws may be necessary for fitting devices to wood, metal, PVC-U or frameless glass doors. For more secure fixing, male and female through-door bolts can be used.
10. Exit devices are not intended for use on double action (double swing) doors unless specifically designed by the manufacturer.
11. The installation instructions must be carefully followed during installation. These instructions and maintenance booklet should be handed over to the end user, building occupier or the authorised representative after completion.
12. Normally the operating element (push bar or touch bar) should be installed at a height of between 900mm and 1100mm above the finished floor level, when the door is in the secured position. Where it is known that the majority of the occupants of the premises will be young children, consideration should be given to reduce the height.
13. For panic devices the horizontal bar should be installed so as to provide the maximum effective length (never less than 60% of the door width)
14. The bolt heads, latches and strikers/keepers should be fitted so as to provide secure engagement. Care should be taken to ensure that no projection of the bolt heads or latches, when in the withdrawn position, could prevent the door swinging freely.
15. Where panic devices are to be fitted to double doorsets with rebated meeting stiles and self-closing devices, a door coordinator device according to EN1158 should be fitted to ensure the correct closing sequence of the doors. Note: This recommendation is particularly important with regard to fire/smoke door assemblies.
16. No additional devices for securing the door in the closed position other than specified herein should be fitted. This does not preclude the installation of self-closing devices.
17. If a door closing device is to be used to return the door to the closed position, care should be taken not to impair the use of the doorway by the young, elderly and infirm.
18. Only strikers or keeps plates provided by the manufacturer should be fitted in order to ensure compliance with the European Standards.
19. For BS EN1125 a sign which reads "push bar to open" or a pictogram should be provided on the inside face of the door immediately above the horizontal bar. The surface area of the pictogram should be no less than 8000mm² and its colours should be white on green background. It should be designed such that the arrow points to the operating element when installed. (see example of pictogram)

It is hereby declared that this device was installed according to the manufacturers instructions

..... Signature and Stamp of Installer

